

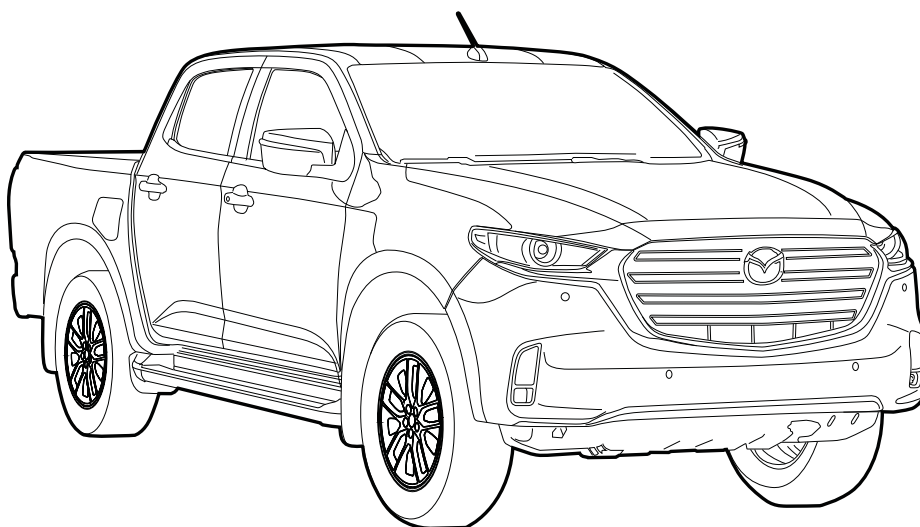

## BT-50 SPORTS BAR TO ROLLTRAC ADAPTOR KIT INSTALLATION INSTRUCTIONS



 0.5 hour  2lbs / 1.2 kg



### IMPORTANT:

Please read each step of these instructions carefully prior to commencing installation!

Place these instructions in the vehicle's glove box after installation is complete



### IMPORTANT:

- Do not use this product in any other motor vehicle for which it is not designed.
- Do not use any other mounting location / method other than described in this instruction.
- It is advisable to seek assistance of another person when installing this product.
- Do not remove the label from the Sports Bar.
- Ensure all torque settings are followed.

Note: This is a polished product. **Beware of belts, buckles zippers, etc. when lifting Sports Bar as these will easily damage the finish.** To avoid corrosion stains, clean up after completion of installation - remove all drill swarf & wipe all fingerprints from car & product.

ACCESSORY PART NUMBER: TF11ACSB

MODEL YEAR: 20/21 ONWARDS

EGR REF No.: KIT038014

FITTING INSTRUCTION No. : SK748

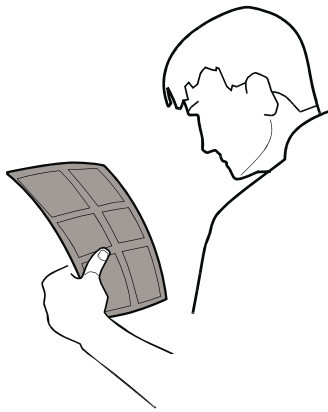
**SAFETY PRECAUTIONS**

Follow all standard workshop and occupational health and safety practices during the installation and re-work process.

Safety glasses, hearing protection and gloves must be used where necessary.

Avoid contact with the hot steel when the vehicle tray is being drilled or cut.

Clean up the swarf immediately to avoid a slipping hazard.

**Important**

Product is decorative only and is not a safety feature!  
Once installed, product does not enhance vehicle structure, integrity or safety.  
The sport bar is not designed to prevent injury or death in the event of a roll-over or other type of accident while the sports bar is installed.

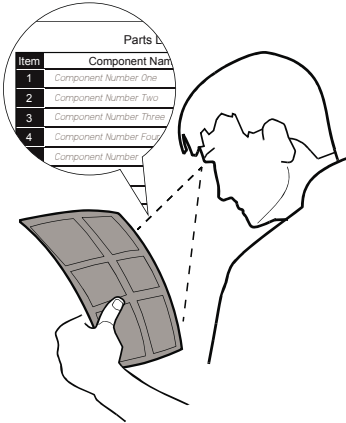
**■ INSTALLATION PRECAUTIONS**

Parts List	
Item	Component Name
1	Component Number One
2	Component Number Two
3	Component Number Three
4	Component Number Four
	Component Number

**STOCKTAKE OF PARTS**

Read instructions thoroughly and check all the supplied Sports Bar parts and fasteners against the bill of materials before commencing the assembly or installation of the Sports Bar.

**■ STOCKTAKE OF PARTS ( PARTS LIST IN ILLUSTRATION IS AN EXAMPLE ONLY )****CLEANING**

Use a firm water spray to remove any loose dirt from the part.

Wash with water, detergent and a soft cloth or sponge.

Do not use petroleum based solvents for polished parts. Surfaces can be maintained using metal polishes

**MAINTENANCE**

Check and re-tighten all securing nuts and bolts every 20,000 km's.

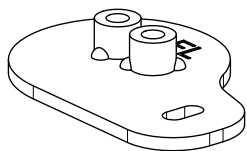
**PARTS LIST**
**1**

Front LHS Foot Plate  
Qty - 1

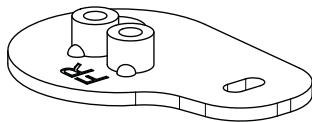
**2**

Rear LHS Foot Plate  
Qty - 1

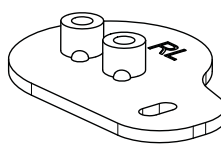
**3**

Front RHS Foot Plate  
Qty - 1

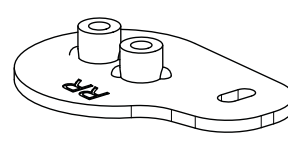
**4**

Rear RHS Foot Plate  
Qty - 1

**5**

M8x40 Counter Sunk  
Socket Head Screw  
Qty - 8

**6**

M8x20 Button  
Head Screw  
Qty - 4

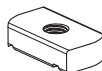
**7**

M8 T-Nut  
Qty - 4

**8**

Washer  
20mmx2mm  
Qty - 4

**9**

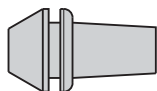

Washer (spacer-front)  
24mmx1.8mm  
Qty - 2

**10**

Rubber Grommet  
Qty - 1

**11**

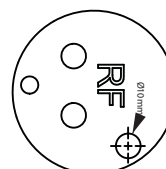

Drill Template  
Qty - 1

**12**

Drill Template  
Qty - 1

**TOOLS REQUIRED**

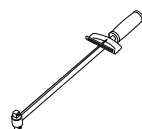
5mm Allen Key



Torque  
Wrench



5mm Allen Head  
Socket



Centre  
Punch



Scissors



Drill



Drill Bits  
4.5mm & 10mm

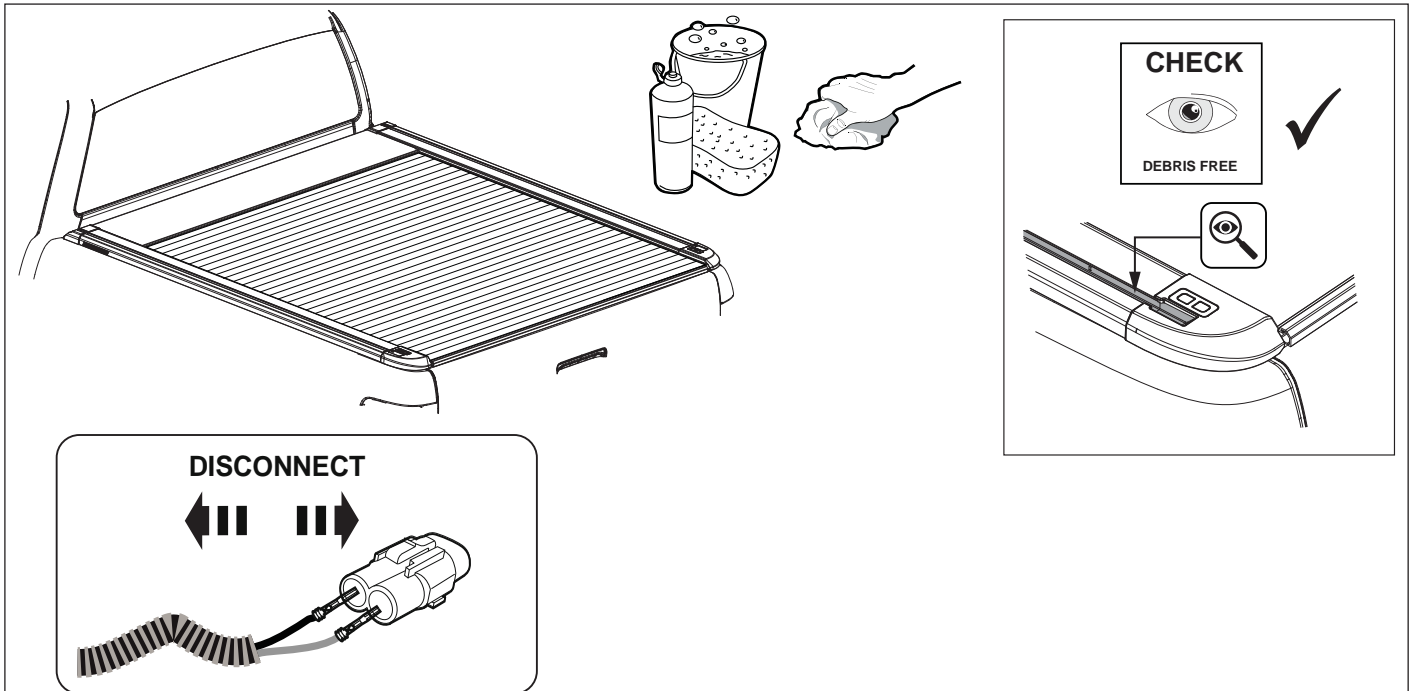

1. Prepare the surface of the side rails by cleaning them thoroughly ensuring that any debris in the side rail channels is completely removed.  
 If there is a Sports Bar fitted, disconnect the brake light harness and dehouse the wires from the connector.  
 Note the wire colours and position for later reinstallation.

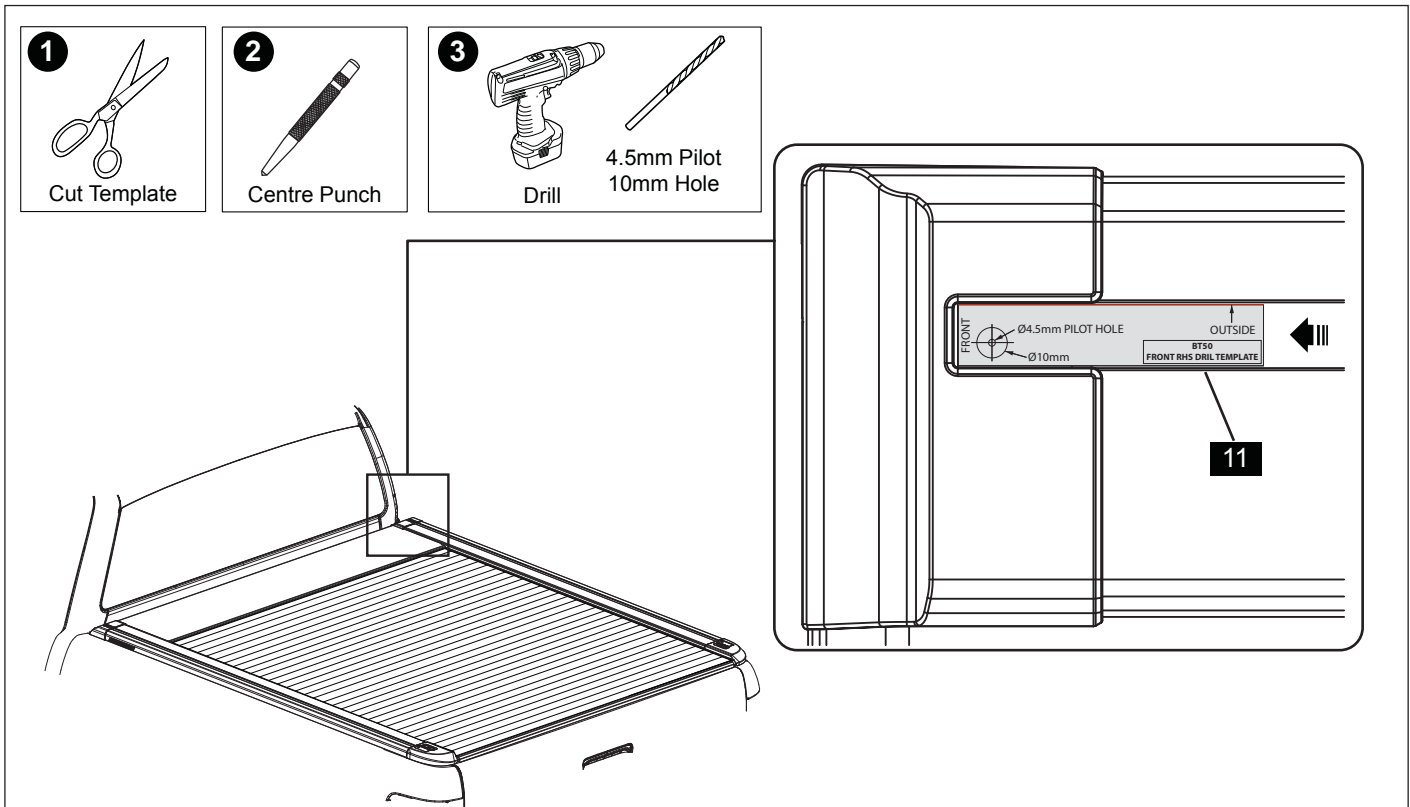

2. Cut out the template (11) on the last page, insert the template into the front RHS side rail channel and push all the way to the front as shown. Centre punch the hole location, drill pilot hole with a 4.5mm drill and then drill a 10mm hole all the way through the side rail. Clean out any swarf from the channel and the tub.

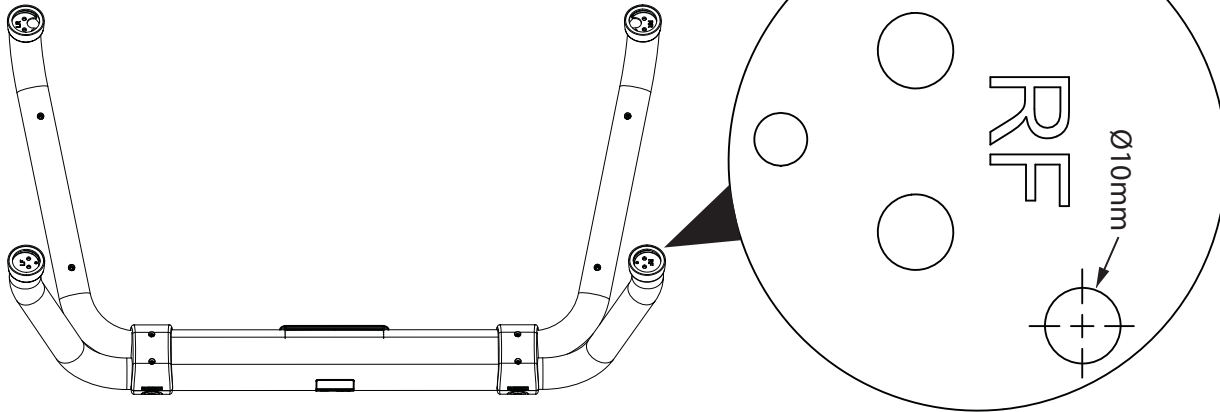
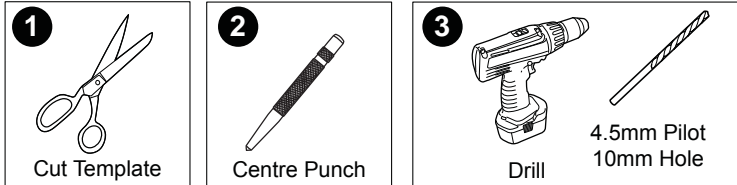

3. If the harness from the Sports Bar brake light is located at the rear leg of the bar, the harness will have to be relocated to the front leg (use the Sports Bar Fitting Instructions SB0047 for assembly). Use drill template located on the last page to position and drill 10mm hole in the base of the front right leg as shown above.

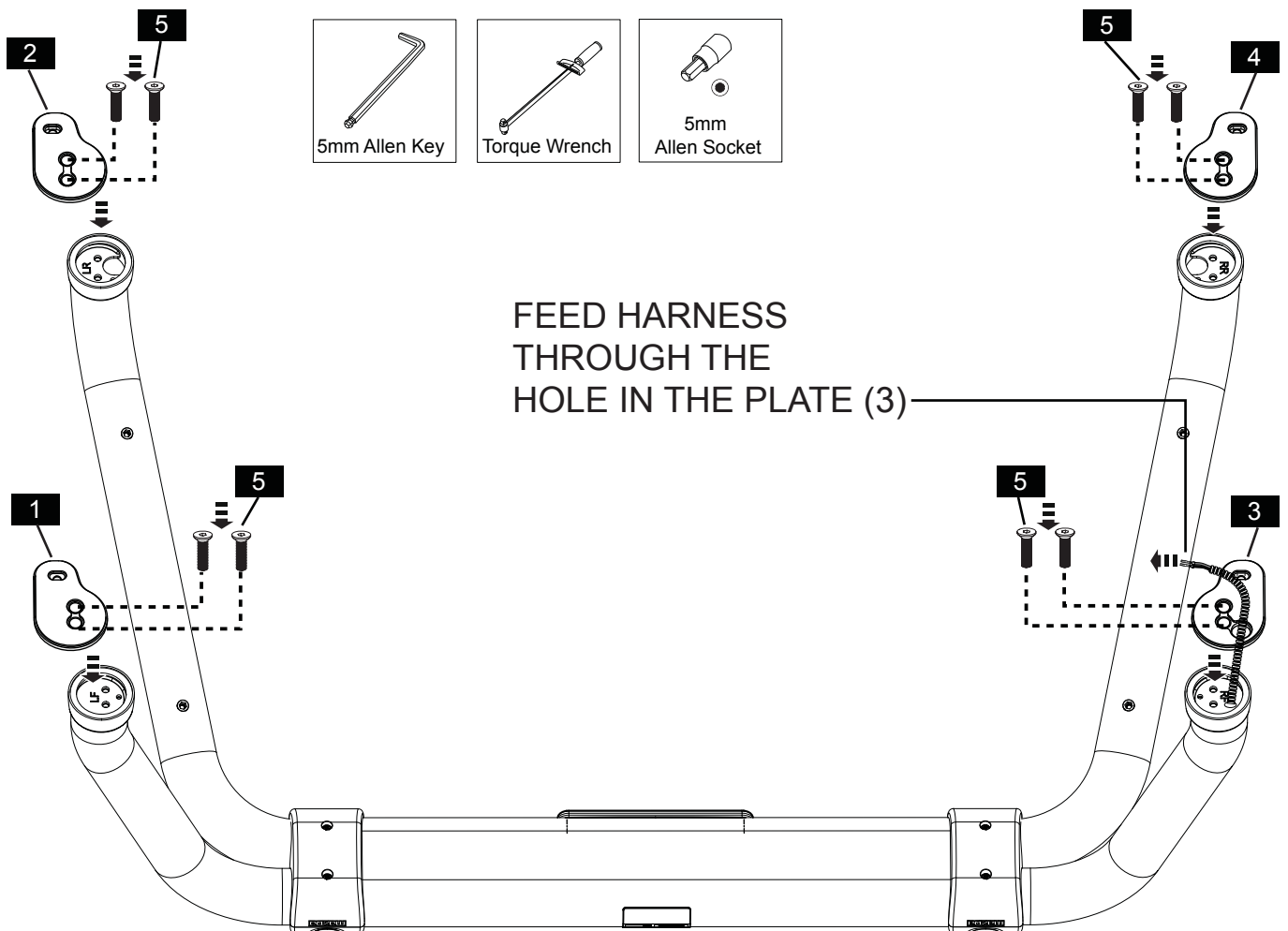

4. Attach the adaptor kit brackets (1),(2),(3),(4) to the respective feet as shown with the M8x40 Counter Sunk Socked Head Screws (5). Temporarily detach the taped loom from the LHS foot and feed it through the footcup and bracket and re-tape it to the LHS tube. Torque all bolts to 21Nm.

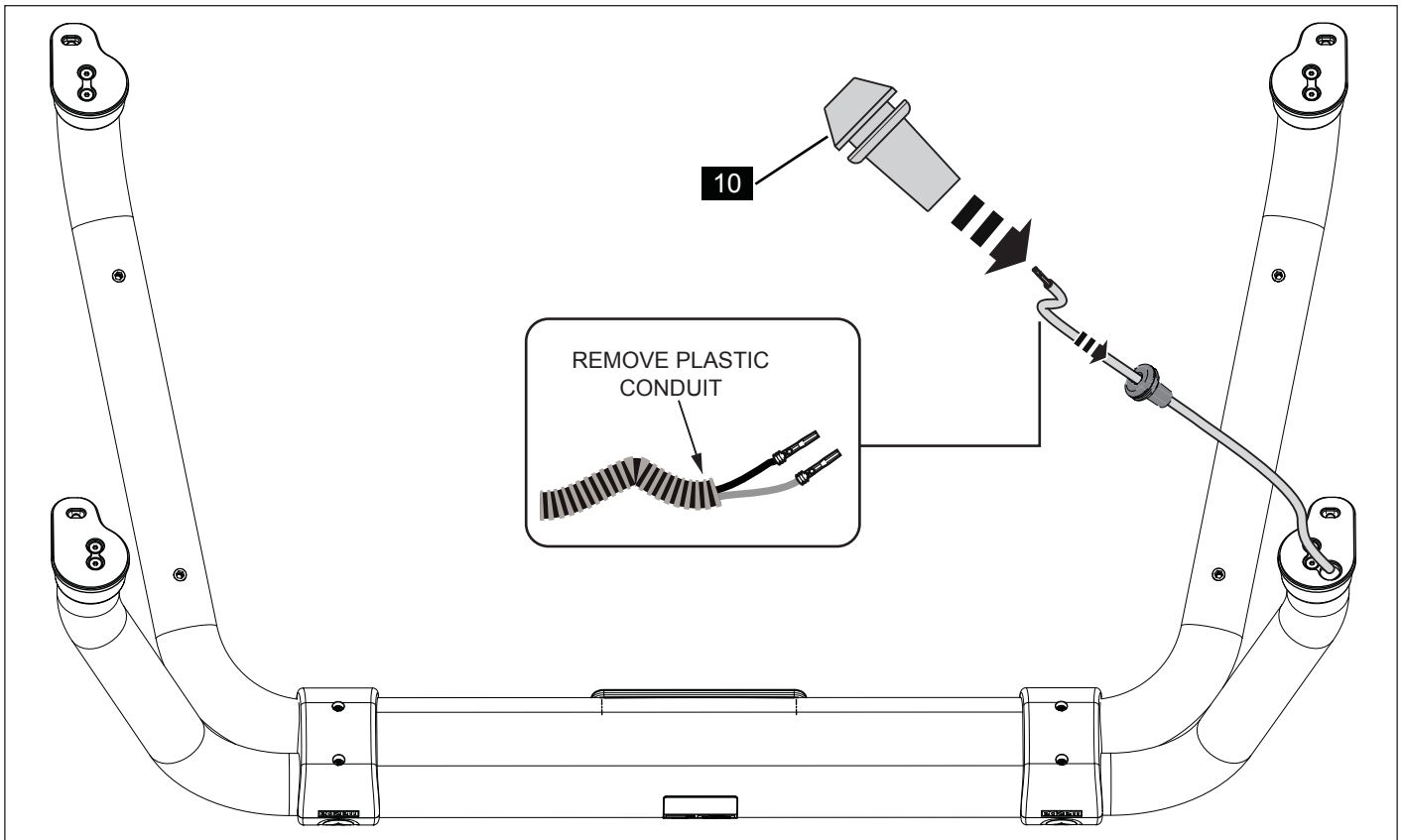

5. Feed the rubber grommet (10) onto the wiring harness hanging from the front right Sports Bar leg. Note the grommet orientation. Note: remove the plastic conduit to allow fitment of the rubber grommet. Refit the plastic conduit once the Sports Bar is fitted.

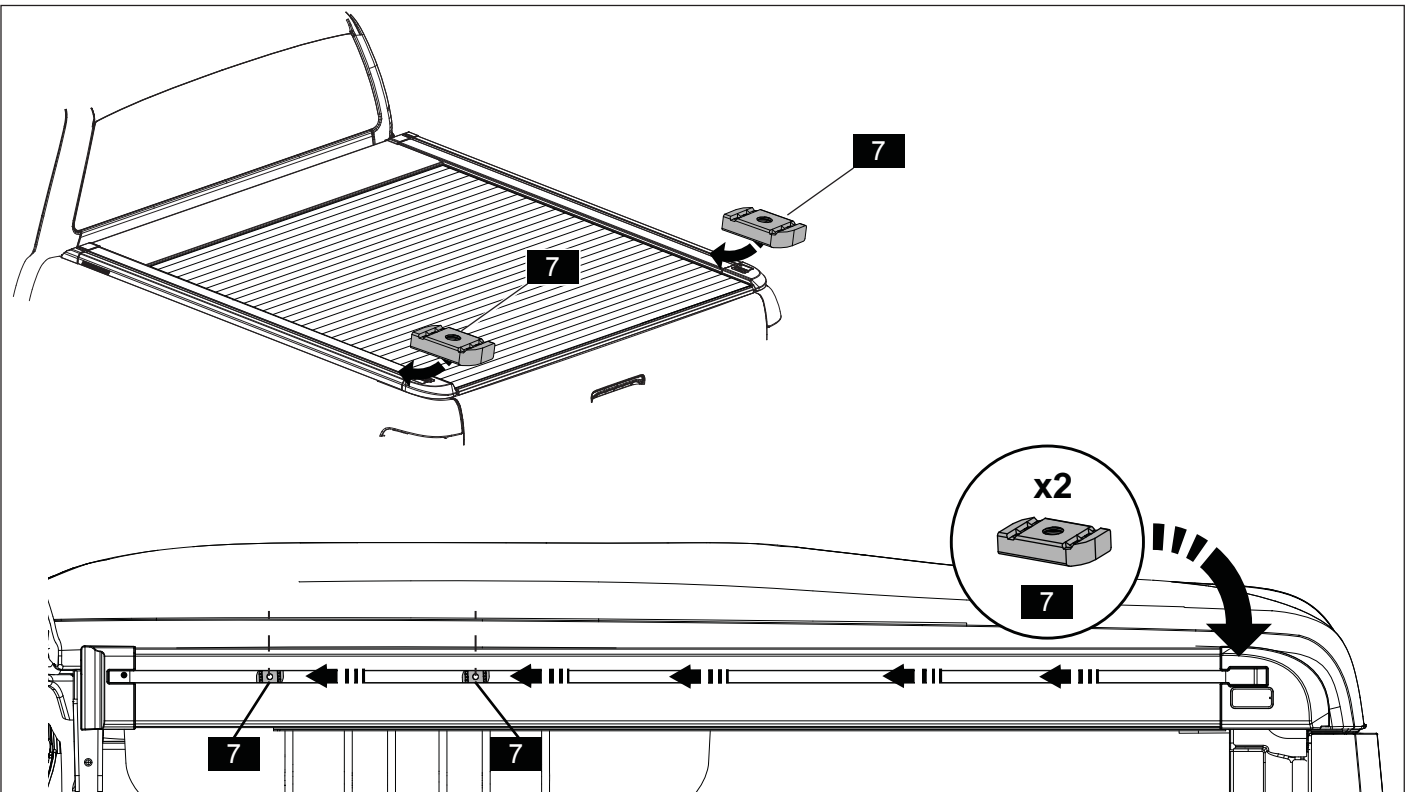

6. Slide two M8 T Nuts (7) into the RHS and LHS T-channel of the side rails as shown. Ensure they align roughly with the holes in the Front and Rear Side Plate on the feet of the Sports Bar. Note: Use tape measure for positioning.

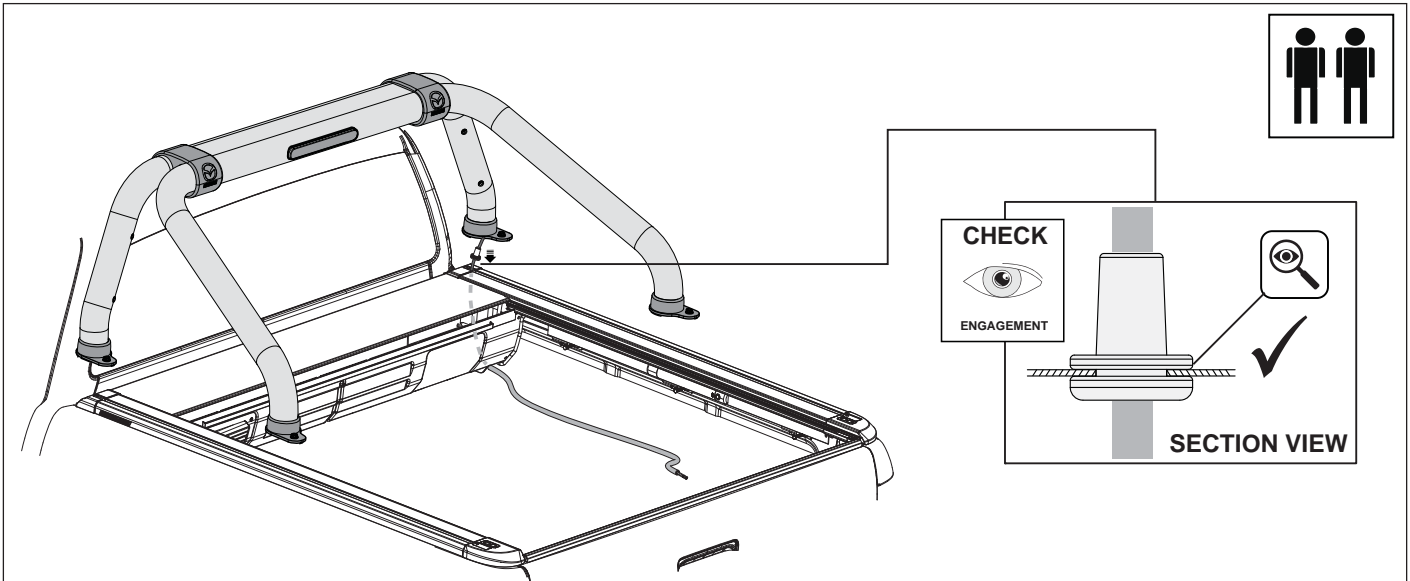

7. Position the Sports Bar above the tub and feed the patch loom and sports bar loom through the hole in the LHS rail. Press the grommet into the hole in the side rail as shown ensuring that it is well seated. Lower the Sports Bar into position over the rail taking care not to pinch the cable.

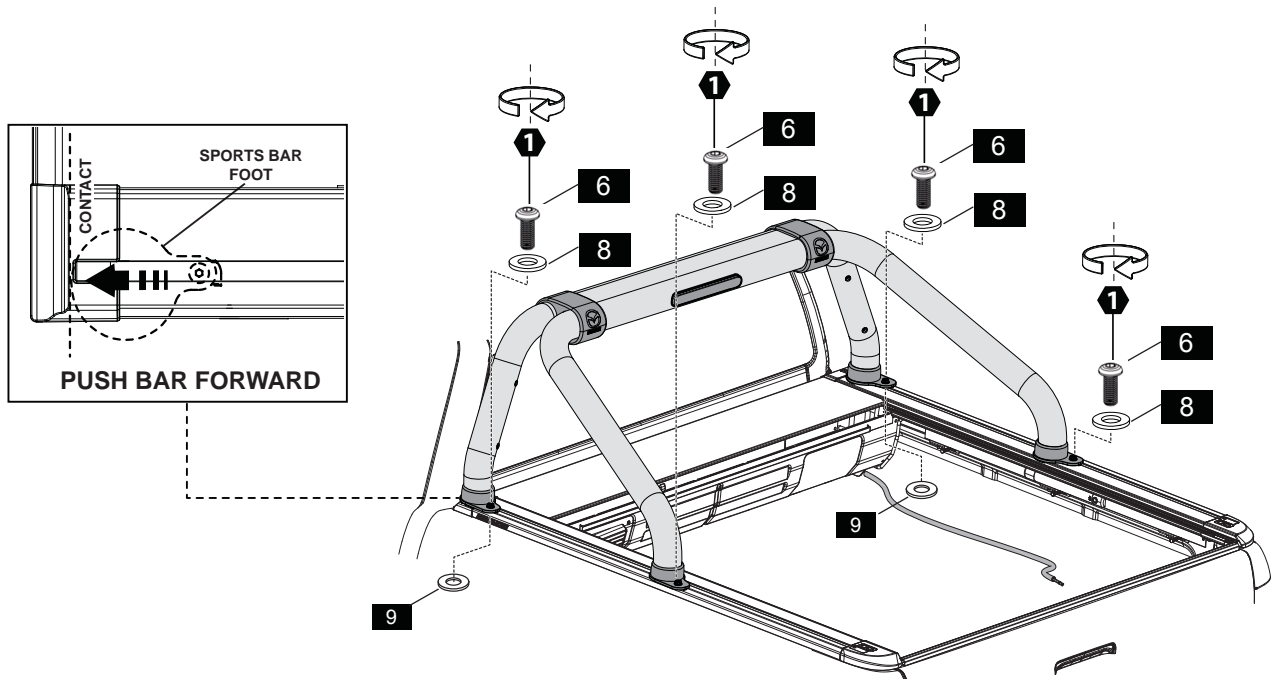
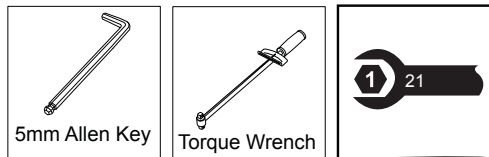

8. Push the Sports Bar forward so that the front feet are aligned with the front of the corner cap as shown. Reposition the M8 T Nuts (7) in the T-channel to align with the holes in the Foot Plates (1),(2),(3),(4). Place a washer (9) under the front foot only and then secure the Sports Bar in place with four M8 Button Head Screws (6) and washers (8). Torque to 21Nm. Refit the previously removed plastic conduit onto the harness.

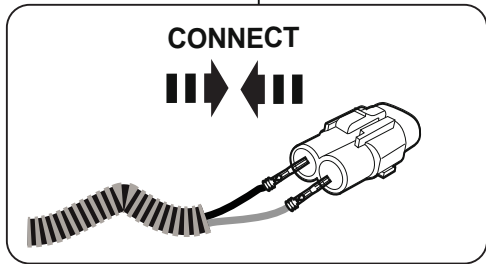
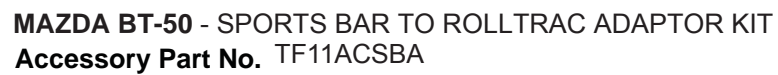

-



**THIS PAGE LEFT BLANK INTENTIONALLY**



## BT50 DRILL TEMPLATES

Sheet Size: A4

Scale: 1:1

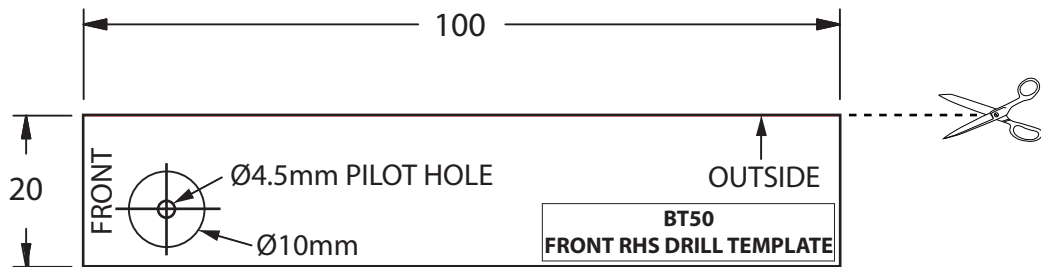

### BT50 DRILL TEMPLATE FRONT RHS BASE RAIL

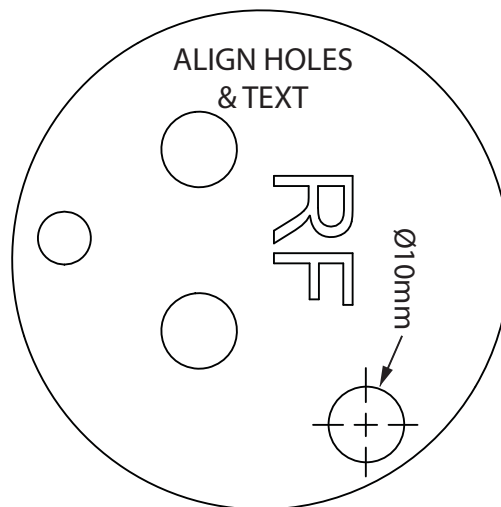

### BT50 DRILL TEMPLATES FRONT RHS SPORTS BAR LEG



Always confirm the length of the 50mm marker before cutting out the templates.

